



# Egress Switch User Network meeting

Bristol

Neil Larkins and Caroline Howard  
Egress Software Technologies  
7th October 2014

- 
- **09:00 Registration and refreshments**
  - **09:30 Welcome**  
Caroline Howard, Egress Software Technologies
  - **09:40 Egress Switch update**  
Caroline Howard, Egress Software Technologies
  - **10:00 Educating your third parties**  
Kelly Prince, Torbay Council
  - **10:15 Refreshment break**
  - **10:30 Egress Switch technical update and roadmap**  
Neil Larkins, Egress Software Technologies
  - **11:30 Q&A**  
The Egress Team
  - **12:00 Close and lunch**



---

## Welcome to the first Egress Switch User Network meeting in Bristol – your chance to:

- Hear about the latest Egress product developments
- Input on the product roadmap
- Have specific questions answered
- Network with peers to ask how they are using Egress Switch



# Egress Switch update

Caroline Howard  
Egress Software Technologies

---

## Agenda

- Egress Switch - update
- Key USPs
- Support for your third parties
- Commercial offers

## The platform:

- Designed to share all forms of electronic information
- Building on core centralised services
- Delivered through four pillars of functionality
- A single community-based licensing model

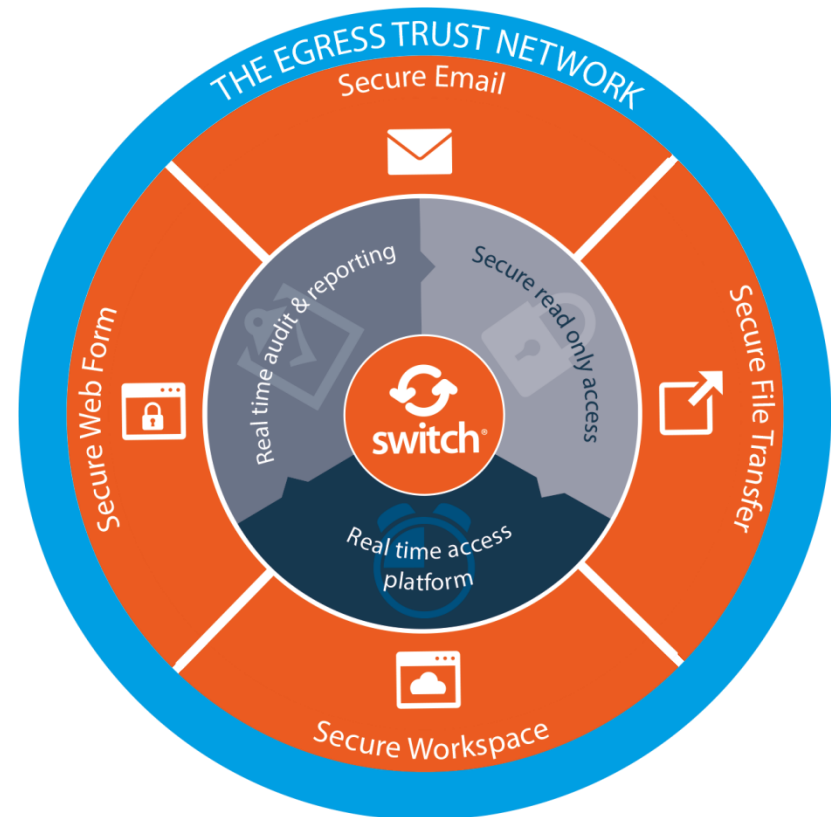

## Switch Secure Email

- Used by 95% of UK local authorities
- The only UK CPA Foundation Grade certified email encryption product



## Switch Secure Email

- Real-time revocation
- Full audit trail
- Multi-layered authentication
- Deployment at the desktop or Gateway
- Integration with MS Outlook
- Automation
- Cloud or on-premise data hosting
- FREE FOR RECIPIENTS TO USE

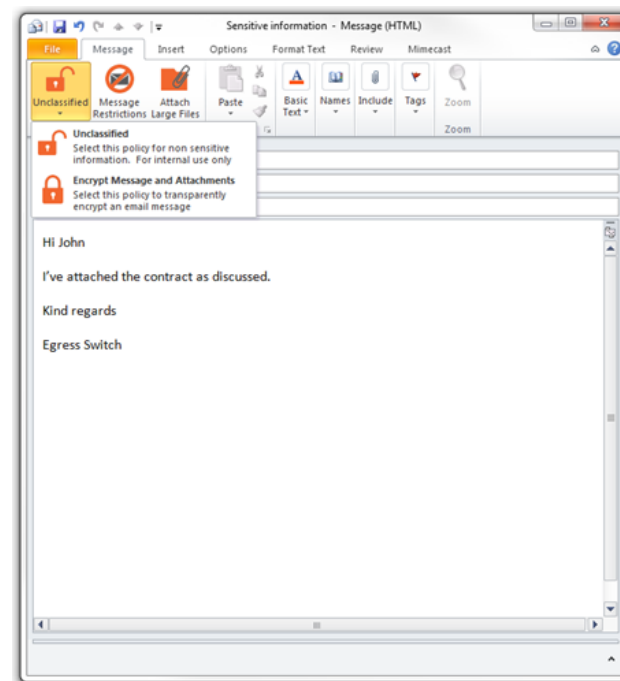



## Switch Secure File Transfer

- A simple way to share files – large and small
- Transfer unlimited files
- No need to use FTP Servers
- Full integration into Microsoft Outlook
- Streamlining file sharing in line with business processes



## Switch Secure File Transfer

- Real-time revocation
- Full audit trail
- Multi-layered authentication
- Deployment at the Desktop or Gateway
- Automation
- Cloud or on-premise data hosting
- FREE FOR RECIPIENTS TO USE

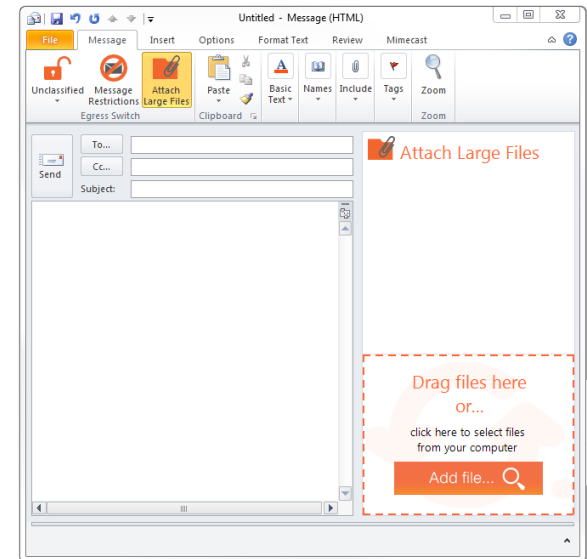

## Switch Secure Web Form

- A simple mechanism for third parties to share sensitive data
- Customisable secure web forms integrated into existing workflows
- Share files of any format and size
- Switch encryption services as standard
- Ability to apply security permissions ensuring only authorised recipients can access and complete the form



## Switch Secure Web Form

- Full audit trail
- Multi-layered authentication
- Automation
- Third party or self-hosted options
- Easy to manage and control
- FREE FOR RECIPIENTS TO USE

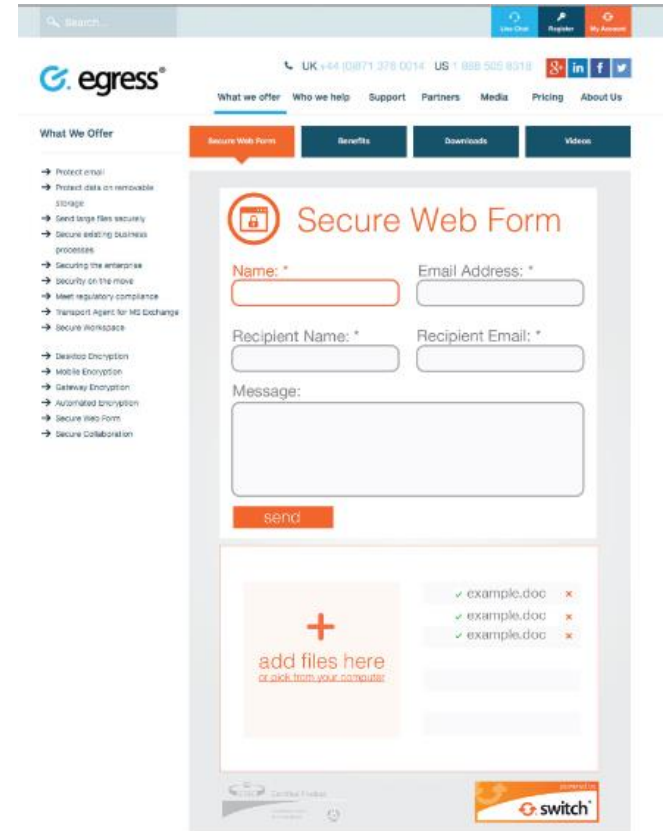

The screenshot displays the Egress Secure Web Form interface. At the top, there is a search bar and navigation links for 'What we offer', 'Who we help', 'Support', 'Partners', 'Media', 'Pricing', and 'About Us'. The 'Secure Web Form' section is highlighted in the navigation menu. The main form area includes fields for 'Name: \*', 'Email Address: \*', 'Recipient Name: \*', and 'Recipient Email: \*'. Below these is a 'Message:' text area and a 'send' button. A file upload section shows a plus sign and the text 'add files here or click from your computer', with three example files listed: 'example.doc', 'example.doc', and 'example.doc'. The footer contains the Egress logo, a 'powered by switch' badge, and social media icons.

## Switch Secure Workspace

- Next generation secure online collaboration
- A secure alternative to Dropbox, Huddle, Box, etc...
- Using government certified key management to protect data at all times



## Switch Secure Workspace

- Full audit, tracking and reporting
- Check-in and check-out functionality
- Easy to use
- Integration with DMS and CMS systems
- Cloud or on-premise data hosting
- Multi-layered authentication
- Automation of data
- FREE FOR RECIPIENTS TO USE

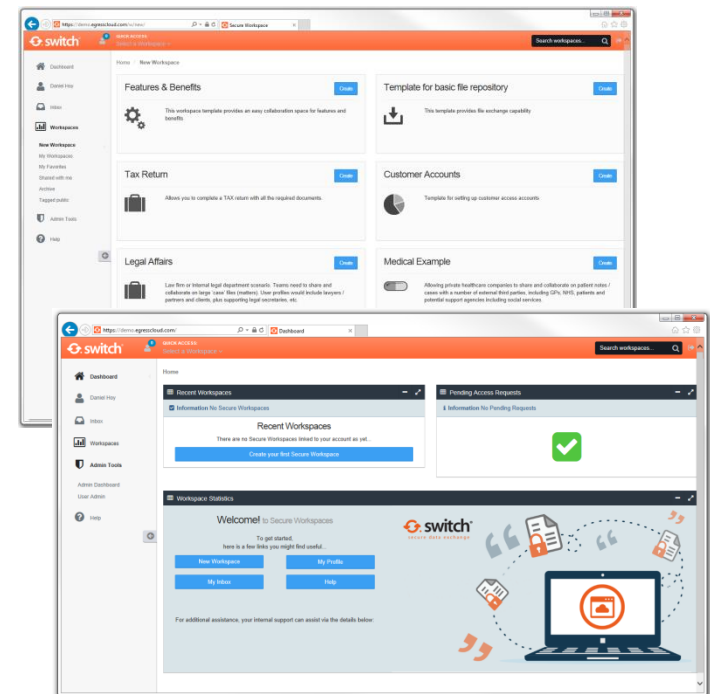



A unique community-based licensing model where free and paying subscribers can share encrypted information with one another unlimited times, using a single global identity.



## USPs



- The first encryption solution to achieve both CESG PGA and CPA certification to OFFICIAL and OFFICIAL-SENSITIVE
- One of the first organisations to achieve ISO 27001 certification against the 2013 standard
- Selected as one of only 30 suppliers under the Cyber Security to Government Scheme
- Winner of the BCS UK IT Industry award in 2011 and 2013 and shortlisted for the 2014 award in November
- Supplier under the G-Cloud 5 and NATO catalogue



HM Government



CloudStore  
Service Provider

NATO IACD  
INFORMATION ASSURANCE TC



## Communication for your third parties?

- Communication packs including:
  - Did you know posters
  - Web content
  - Egress Switch user guides
  - Email templates (internal and external)



## What support is available to free subscribers?



- The Egress support centre is available to all Switch users  
<http://www.egress.com/create-support-ticket/>
- Online tutorial videos <http://www.egress.com/online-tutorials/>
- A user knowledge base <http://www.egress.com/technical-knowledge-base/>
- Free apps <http://www.egress.com/downloads/>
- Other data sheets, case studies and technical documentation  
<http://www.egress.com/resources-and-downloads/>
- Ability to access, reply and initiate communication with all customers on the Switch network

# Educating your third parties

## Torbay Council's perspective

Kelly Prince  
Information Governance Lead



---

## Project scope

- Implement secure email software for unitary authority of 1,300 core staff
- Enable secure (large) file transfer to external parties
- Promote end-user control
- Reduce risk of monetary penalty



---

## Requirements

- Social care:
  - Foster carers, Adoption Panel
- Schools
- Legal:
  - Solicitors
- Human Resources



---

## Schools

- 15 council-maintained schools
- 22 academies
- Three others
  
- Need to transfer information securely with these schools
- No access to GCSX



## Example

- School sent email plus attachment containing sensitive data to a large number of parents
- Use of Switch would have prevented email from being read or printed
- Switch was recommended – ICO were notified
- School buying own license through special offer with the council



---

## Results and the way forward

- Over 200 Switch packages sent per week
- Schools becoming licensees
- Children's Services working towards paperless environment
- Reduction in email breach incidents
- To carry forward expansion of use of Switch and third parties





## Questions

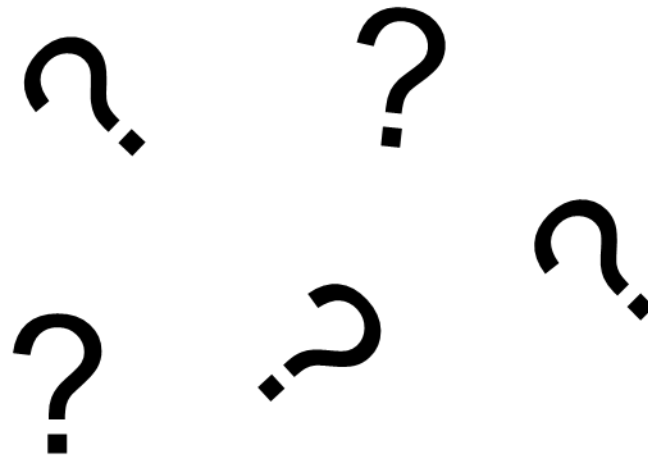

Thank you

[kelly.prince@torbay.gov.uk](mailto:kelly.prince@torbay.gov.uk)

01803 207412





# Egress Switch Technical update

Neil Larkins  
Egress Software Technologies

---

## Agenda

- Egress Switch new functionality review
- Egress Switch v4.2 release
- New products and services
- Open forum / Q&A

## Egress Switch new functionality review

- Multi-layer authentication  
*Provide additional levels of assurance over the identity of third party recipients*
- Active Directory integration and Auto User Enrolment  
*ADFS cloud services and Switch Gateway Automatic User Enrolment*
- Secure access  
*Rights management capabilities available to control third party access to sensitive information*

# Egress Switch V4.2

## Switch Secure File Transfer

- The large file transfer capability receives a new User Interface, and enhanced configuration and integration points
- Core Switch application has redesigned User Interface and icons

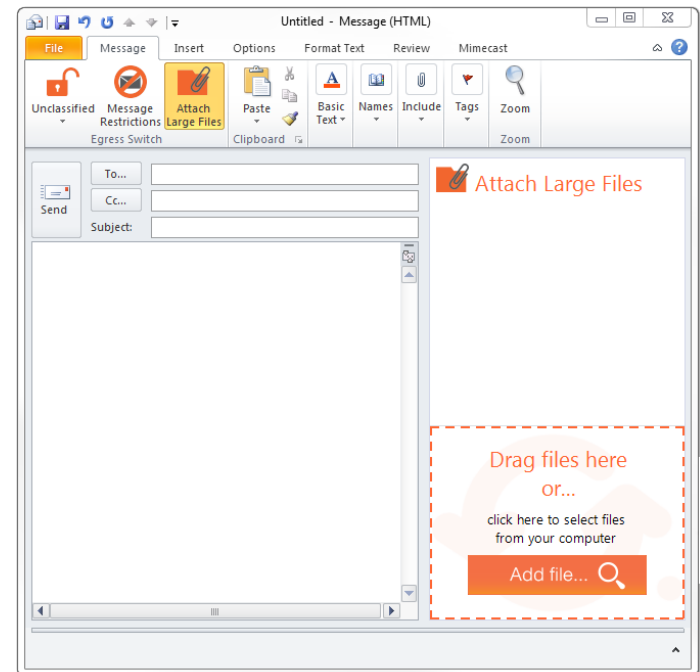

## Email and document classification

- Classify email message body and attachments at the point of send and release

Classification: **Official**

Hi John

As requested, please find attached the information on client transactions

Kind Regards

Neil

This message was classified by **Neil Larkins** (neil.larkins2@egressit.com) at Mon, 23 Jun 2014 15:35:59 GMT

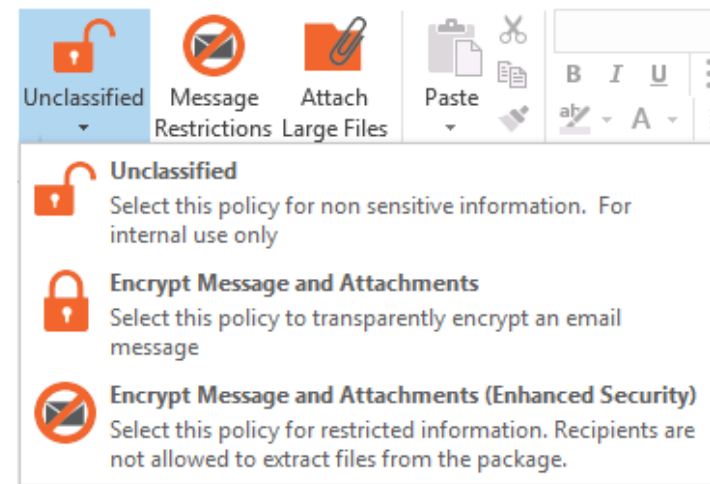

## Mobile apps

- Significant updates to all mobile apps
- Release of Windows Phone 8.1 app
- Integration with Switch Secure Workspace





---

## CESG states:

- We need to think about the real risks to our information and give it the right levels of protection at all points we're responsible for it
- We treat this information as OFFICIAL / OFFICIAL-SENSITIVE when we are responsible for it, and when we need to share it with environment X, we will use the most appropriate technology to ensure safe delivery to that space whilst maintaining our network's protection

## Delivering confidence through technology...

- Products certified under the Commercial Product Assurance (CPA) scheme
- Service accredited under Pan Government Accreditation (PGA)



- 
- Egress Switch Client for MS Windows, including the MS Outlook Add-in (Desktop Email Encryption)
  - Egress Switch Gateway for MS Windows Server (Gateway Email Encryption)
  - Egress Server Infrastructure for MS Windows (Key Management and Policy Server)
  - Desktop to Desktop Encryption / Decryption
  - Desktop to Gateway Encryption / Decryption
  - Gateway to Gateway Encryption / Decryption

- A number of security related changes were made on the back of feedback from CESG
- Development procedures and methodology were all reviewed
- A complete review of documentation and implementation procedures



## Switch Secure Web Form

- Custom secure web forms integrated into workflow and systems with data encryption
- Hosted or self-hosted options
- Custom branding with tight integration into existing websites and portals

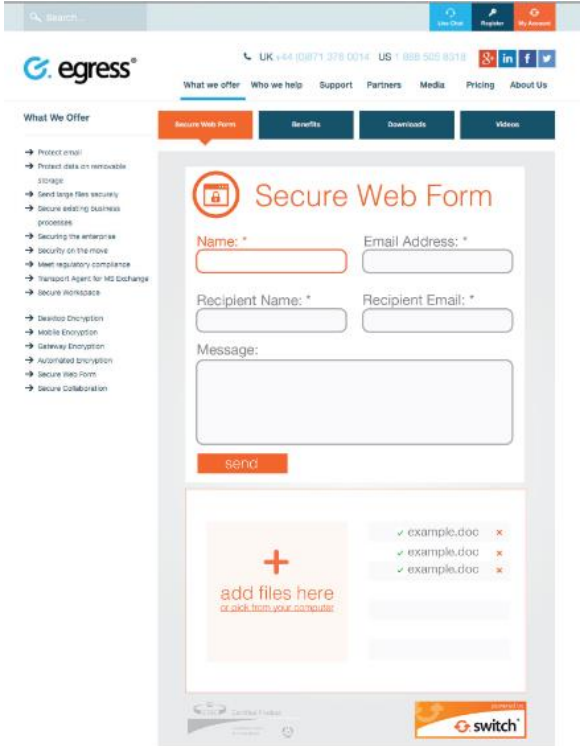

The screenshot displays the Egress Secure Web Form interface. At the top, there is a navigation bar with the Egress logo, contact information for the UK and US, and social media links. Below this is a 'What We Offer' section with a list of services including email protection, data storage, file transfer, and encryption. The main form area is titled 'Secure Web Form' and contains fields for Name, Email Address, Recipient Name, Recipient Email, and a Message. A 'send' button is located below the message field. At the bottom, there is a section for adding files, with a list of example files (example.doc) and a 'switch' logo.

What functionality / features  
would you like to see?

Open Forum

Q&A



Egress Switch  
**usern**etwork

Thank you for your time

E: [info@egress.com](mailto:info@egress.com)

T: +44 (0) 2076248500

W: [www.egress.com](http://www.egress.com)

Twitter: @EgressSwitch